

Add WiFi Remote Control

- (4) Enter the WiFi password and click Next. The device has been successfully added. Click "Finish".

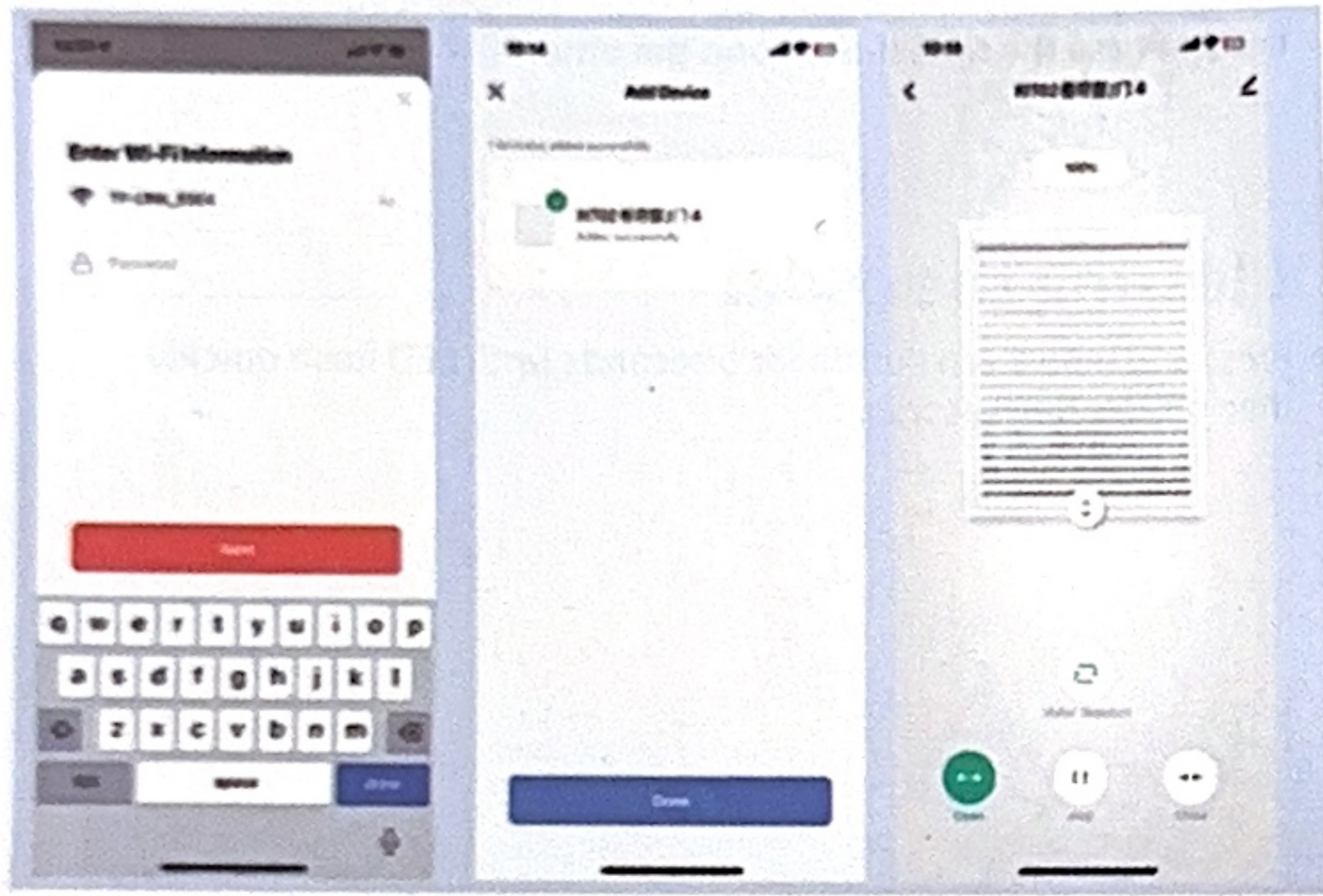

Device Unbind

Method 1:

- 1) Select the icon in the upper right corner of the device, select "Remove Device" at the bottom, Disconnect, and Confirm.
- 2) The blue light on the remote control remains on and then starts flashing. After 3 minutes of no operation, the indicator light remains on and enters standby mode.

Note: Within 3 minutes of flashing, you can directly re-enter the distribution network state.

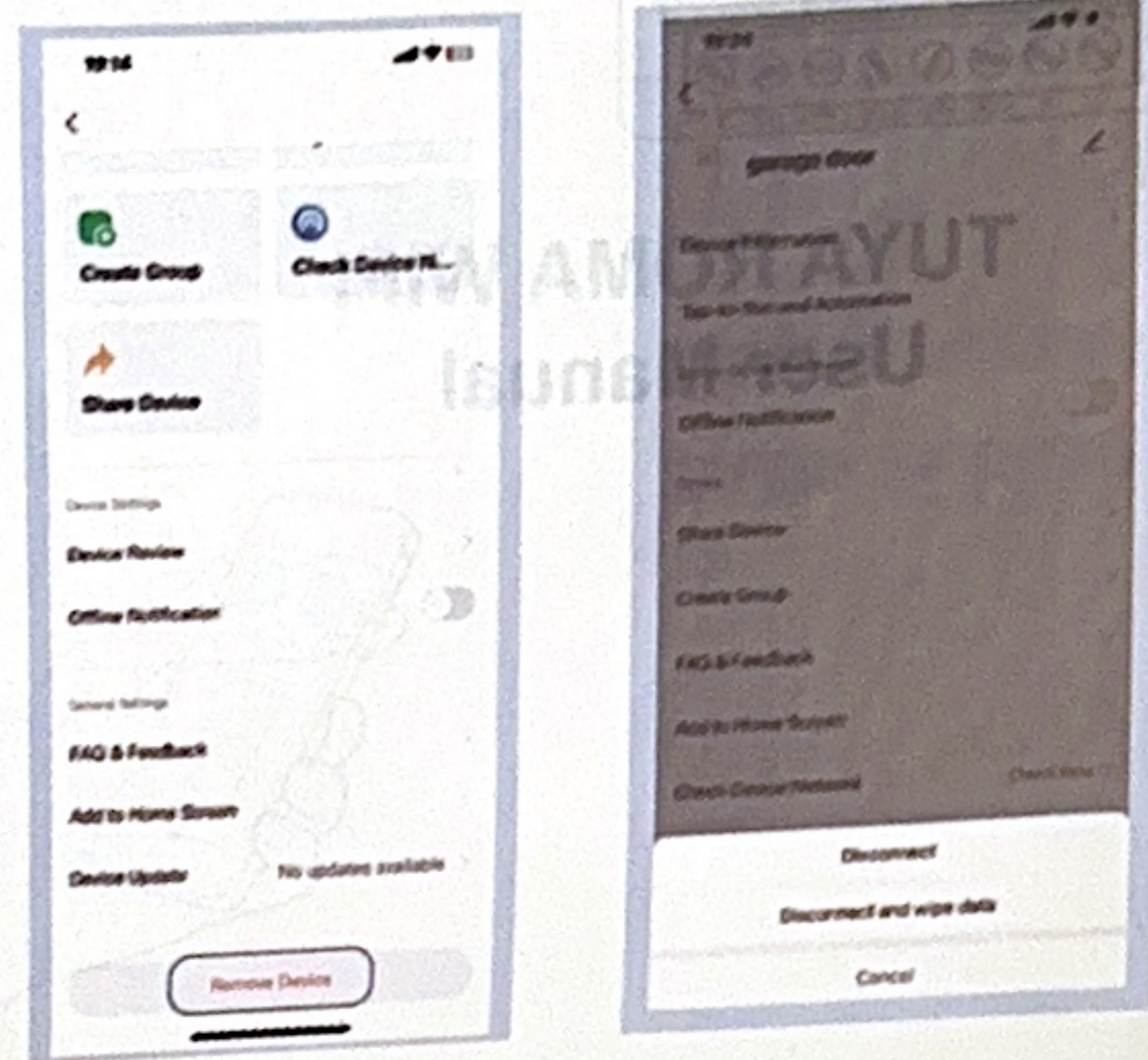

Device Share

- 1) Select the icon in the upper right corner of the device, select "Share Device", and share the link.
- 2) The recipient of the sharing, click on the sharing link, and follow the prompts. Enter the app and confirm receiving the shared device.
- 3) After receiving, the shared device I received appears on all devices. Entering the device allows control of the device.

Note: If multiple people want to control the device, it can be shared through the device.

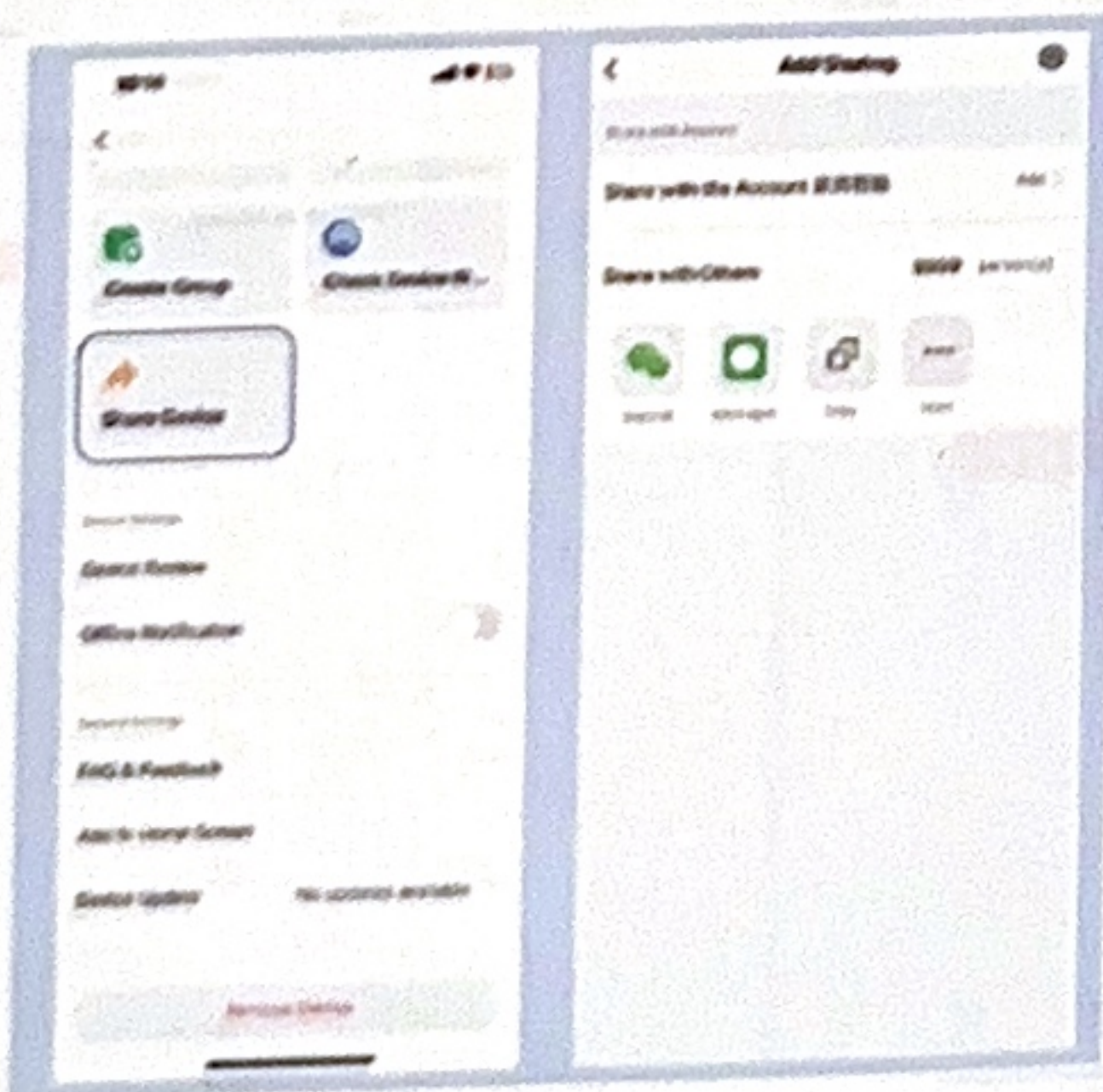

Dear Users:
Thank you for purchasing
our products!

Follow these steps to configure

APP Installation

- 1) Search for Tuya Smart app or Smart Life app in the application market, or scan the QR code as below, and choose to install them.



Download QR code

- 2) Open the app after installation is complete, then log in by your phone number.

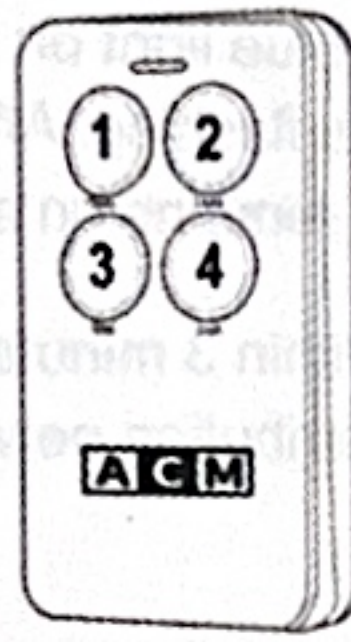
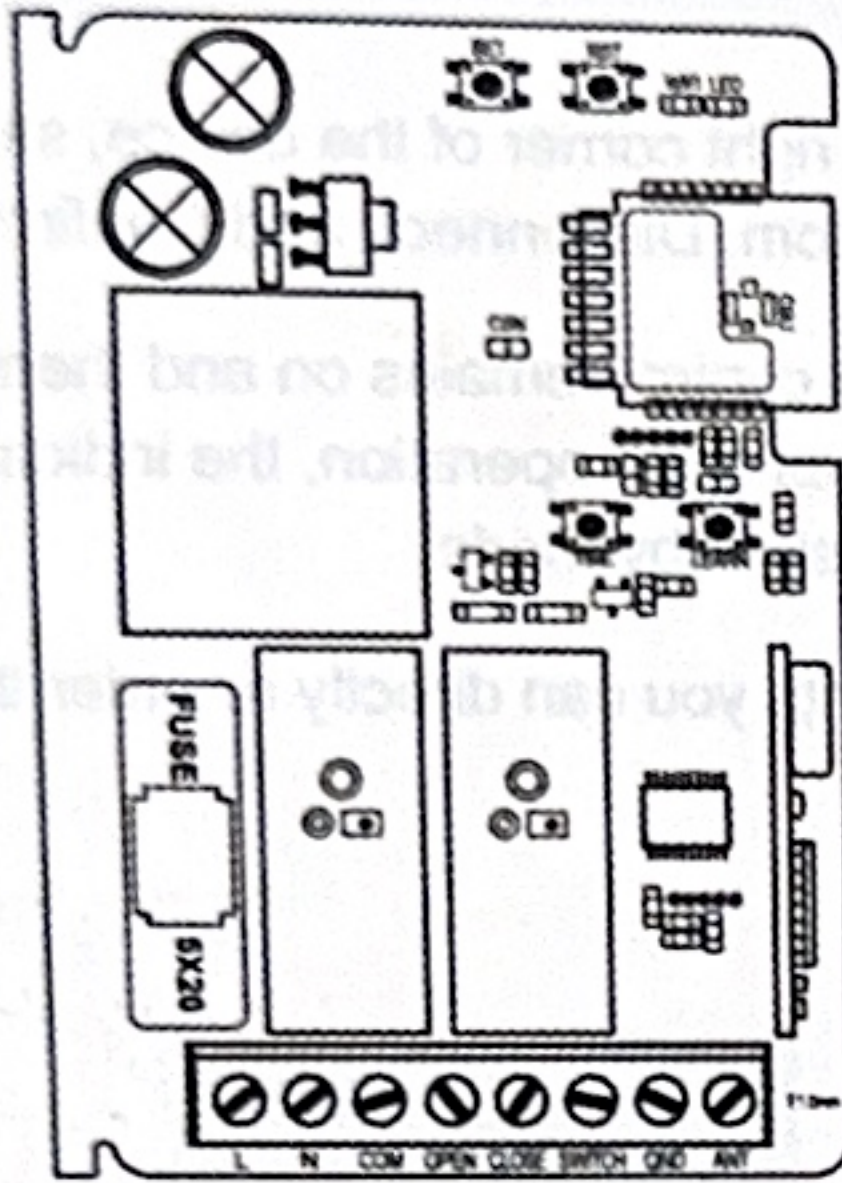

TUYA ROMA WIFI User Manual

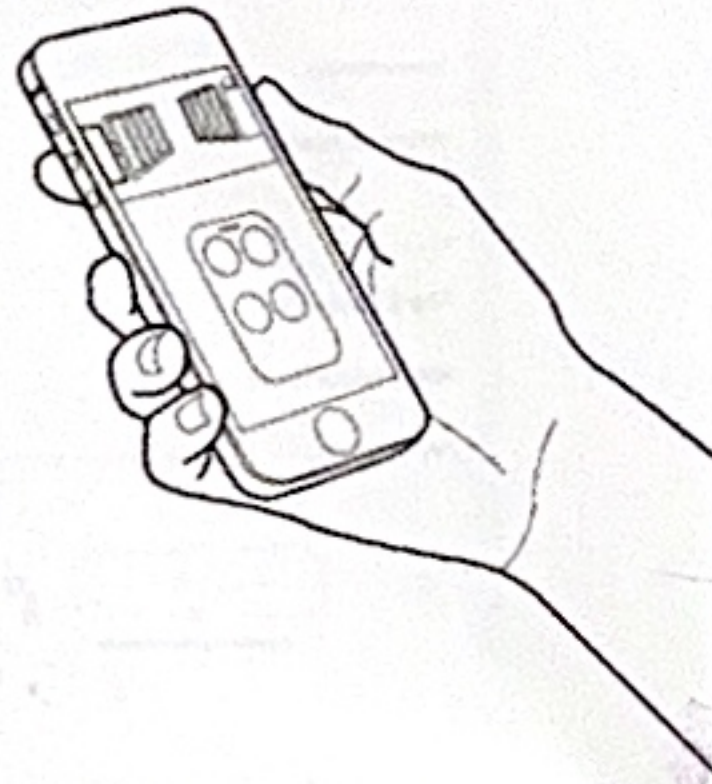

Remote programming:

1. on control board, press LEARN button then release, on remote control, press and hold any remote control button until LED flash quickly then off, programming success.

Motor time setting:

Make the door Total close, on control board, press and HOLD time button, door starts open, and after reach the point you need, release the time button, and the time will be stored itself.

Clearing the code:

Press and hold learn button for 5 seconds, until LED flash quickly then off, clearing success.

Dear Users: Thank you for purchasing our products!

Follow these steps to configure

APP Installation

- 1 Search for Tuya Smart app or Smart Life app in the application market, or scan the QR code as below, and choose to install them.



download QR code

- 2 Open the app after installation is complete then log in by your phone number.

Add ROMA Wifi control board

• Add Device

- (1) When the roma control board is powered on, the blue wifi LED remains on which means entering standby mode.
- (2) Enter the Tuya APP and click "Add Device" on the Home screen. Press the set button on the remote control for about 5 seconds, and the wifi LED will start flashing, entering the distribution network state.
- (3) The app automatically searches for new device, discover them, and click "Add Device".

